

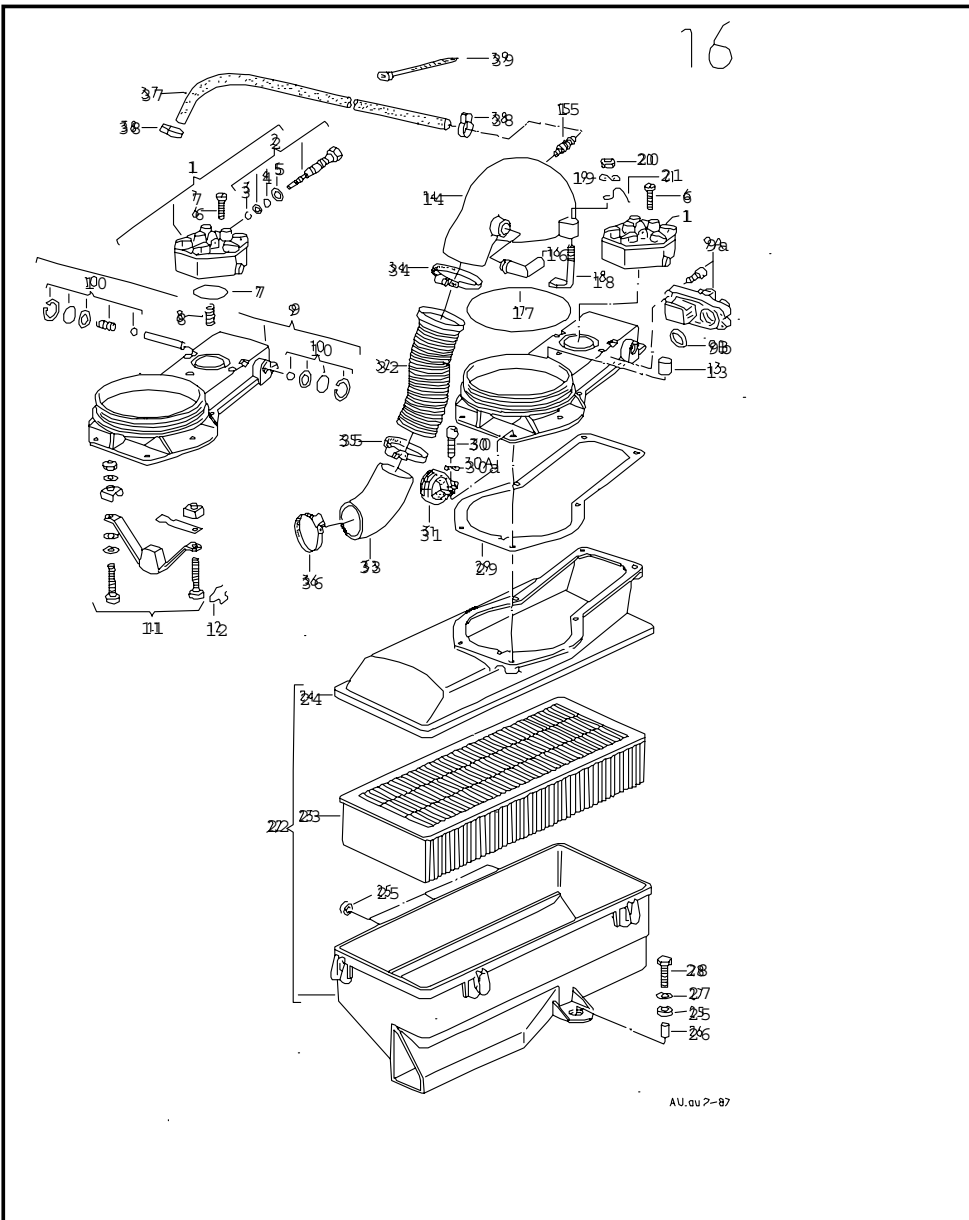

Model	Year	MG:	SG:	Illustration	Restrictions	Update	21:36	18.04.2005		ETKA	
QUAT	83	1	33	16-00		525					



Pos	Part Number	Name	Remarks	Qty	Model
		fuel metering valve mass air flow sensor intake air duct			WX
1	035 133 481 M	fuel metering valve F 85-D-900 582>>		1	
2	035 198 685	parts kit for fuel metering valve		1	
-	035 198 691	set of gaskets for fuel metering valve		1	
3	035 133 487	sealing washer	4MM	1	
4	035 133 485 A	sealing washer	7MM	1	
5	N 013 813 1	sealing washer F >> 85-D-900 581	A12X17	1	
(5)	N 013 830 2	sealing washer F 85-D-900 582>>	A8X12	1	
6	035 133 483 C	screw, cheese hd.		3	
7	034 133 476	round seal	29,5X1,5	1	
8	035 133 543 B	pressure spring		1	
9	035 133 471 P	mass air flow sensor		1	
10	063 133 417	control lever mounting		1	
11	063 133 419	stop		1	
12	035 133 478 A	retaining clip		1	
(13)	049 133 777 B	plug for co-adjusting screw		1	
14	035 133 357 P	intake air duct		1	
15	035 145 741 H	control jet		1	
(15)	035 145 741 G	control jet		1	